

# Technical data sheet



## Product features

### Freezing cabinet 852 l pastry version

<b>Model</b>	<b>SAP Code</b>	00013354
MFP 900	<b>A group of articles - web</b>	Refrigeration and freezer cabinets



- GN / EN size in device: EN 600x400
- Chamber volume [l]: 852
- Minimum device temperature [°C]: -18
- Maximum device temperature [°C]: -22
- Insulation thickness [mm]: 60
- Automatic defrost: Yes
- Annual energy consumption [kWh]: 4088

<b>SAP Code</b>	00013354	<b>Gross Volume [m3]</b>	1.877
<b>Net Width [mm]</b>	740	<b>Net Volume [m3]</b>	1.473
<b>Net Depth [mm]</b>	990	<b>Number of GN / EN</b>	10
<b>Net Height [mm]</b>	2010	<b>GN / EN size in device</b>	EN 600x400
<b>Net Weight [kg]</b>	134.00	<b>Minimum device temperature [°C]</b>	-18
<b>Power electric [kW]</b>	0.650	<b>Maximum device temperature [°C]</b>	-22
<b>Loading</b>	230 V / 1N - 50 Hz	<b>Refrigerant</b>	R290
<b>Energy class</b>	E	<b>Refrigerant weight [g]</b>	120.00
<b>Chamber volume [l]</b>	852	<b>Climate class</b>	4

# Technical data sheet



Technical drawing

## Freezing cabinet 852 l pastry version

<b>Model</b>	<b>SAP Code</b>	00013354
MFP 900	<b>A group of articles - web</b>	Refrigeration and freezer cabinets

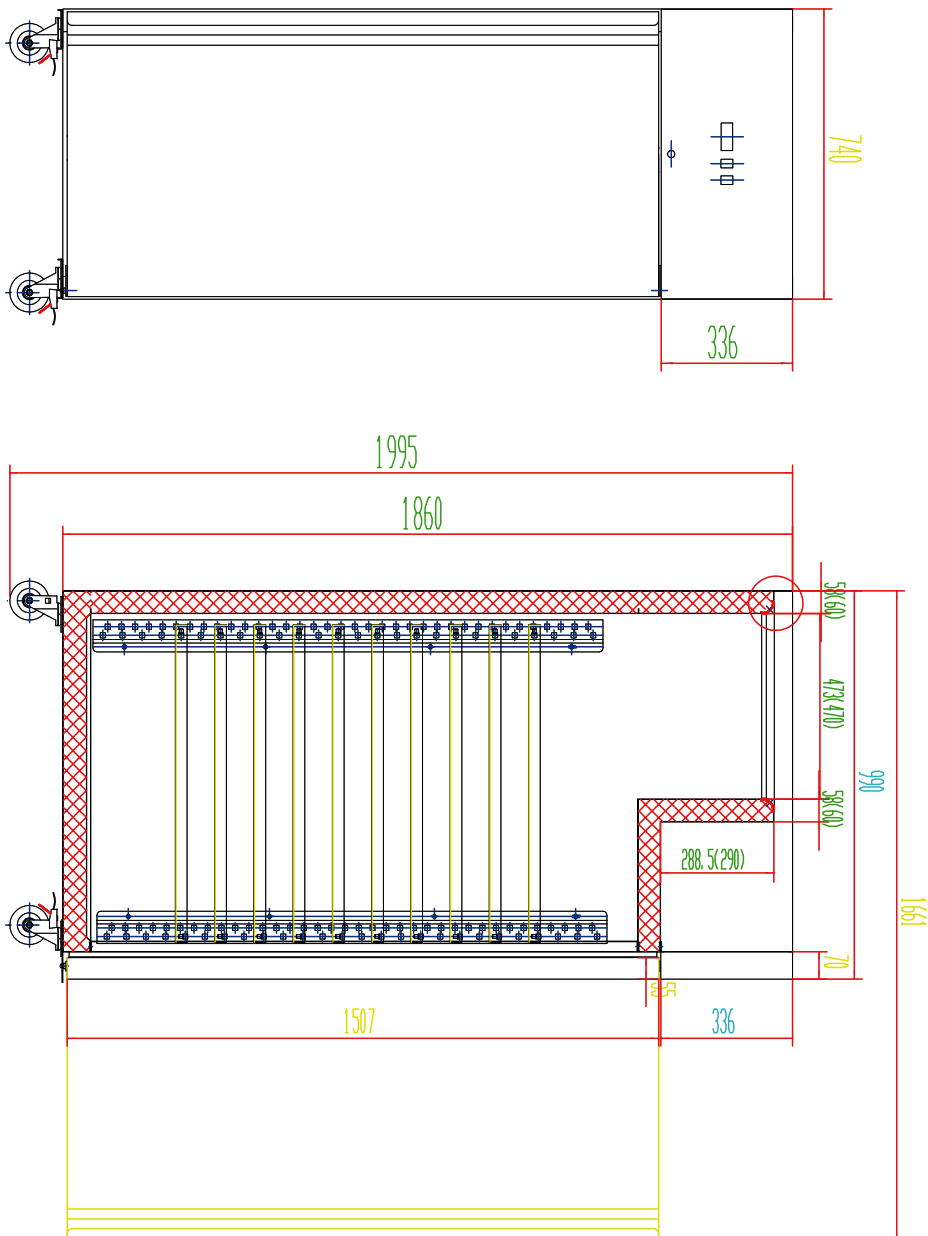

# Technical data sheet



## Technical parameters

### Freezing cabinet 852 l pastry version

<b>Model</b>	<b>SAP Code</b>	00013354
<b>MFP 900</b>	<b>A group of articles - web</b>	Refrigeration and freezer cabinets

**1. SAP Code:**

00013354

**2. Net Width [mm]:**

740

**3. Net Depth [mm]:**

990

**4. Net Height [mm]:**

2010

**5. Net Weight [kg]:**

134.00

**6. Gross Width [mm]:**

840

**7. Gross depth [mm]:**

1090

**8. Gross Height [mm]:**

2050

**9. Gross Weight [kg]:**

146.00

**10. Device type:**

Electric unit

**11. Power electric [kW]:**

0.650

**12. Loading:**

230 V / 1N - 50 Hz

**13. Energy class:**

E

**14. Refrigerant:**

R290

**15. Material:**

Stainless steel

**16. Exterior color of the device:**

Stainless steel

**17. Min ambient temperature [°C]:**

18

**18. Max ambient temperature [°C]:**

43

**19. Device properties 2:**

Bakery

**20. GN / EN size in device:**

EN 600x400

**21. Number of GN / EN:**

10

**22. Chamber volume [l]:**

852

**23. Gross Volume [m3]:**

1.877

**24. Net Volume [m3]:**

1.473

**25. Worktop material:**

SS201

**26. Adjustable feet:**

Yes

**27. Insulation thickness [mm]:**

60

**28. Annual energy consumption [kWh]:**

4088

# Technical data sheet



Technical parameters

## Freezing cabinet 852 l pastry version

<b>Model</b>	<b>SAP Code</b>	00013354
MFP 900	<b>A group of articles - web</b>	Refrigeration and freezer cabinets

**29. Minimum device temperature [°C]:**

-18

**33. Number of grids:**

10

**30. Maximum device temperature [°C]:**

-22

**34. Climate class:**

4

**31. Automatic defrost:**

Yes

**35. Cross-section of conductors CU [mm<sup>2</sup>]:**

0,5

**32. Refrigerant weight [g]:**

120.00